

Material	h1	h2	h3	d2	d3	Metric thread	Length	Code						
Carbon steel Copper plated	0.7	0.6	6.5	6.5	0.9	M4x0.7	8	488-M4-8						
							10	488-M4-10						
							12	488-M4-12						
							16	488-M4-12						
							20	488-M4-20						
							25	488-M4-25						
	0.7	0.8	7.5	7.5	1.05	M5x0.8	10	488-M5-10						
							12	488-M5-12						
							16	488-M5-16						
							20	488-M5-20						
							25	488-M5-25						
							0.7	0.8	7.5	7.5	1.10	M6x1.0	10	488-M6-10
	12	488-M6-12												
	16	488-M6-16												
	20	488-M6-20												
	25	488-M6-25												
	30	488-M6-30												
	0.8	0.85	9	9	1.15	M6x1.25	12	488-M8-12						
							16	488-M8-16						
							20	488-M8-20						
							25	488-M8-25						
							0.8	0.85	9	9	1.15	M6x1.25	12	488-M8-12
							16						488-M8-16	
	20	488-M8-20												
25	488-M8-25													

* All dimensions are in mm

489 | RIVET NUT

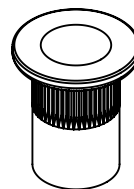
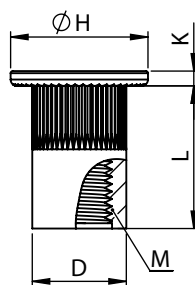

L	D	H	K	Grip range	Hole diameter	Metric thread	Code
10	5.9	9	0.8	0.3 - 2.5	6	M4x0.7	489-M4
12	6.9	10	1	0.3 - 2.5	7	M5x0.8	489-M5
14	8.9	13	1.5	0.5 - 3.0	9	M6x1.0	489-M6
17	10.9	15.5	1.5	0.5 - 3.0	11	M8x1.25	489-M8
19	12.5	17.5	2	1.0 - 3.5	13	M8x1.5	489-M10

* All dimensions are in mm