

Version 1

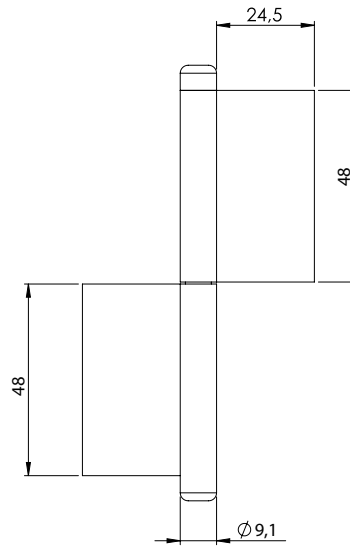

Version 3

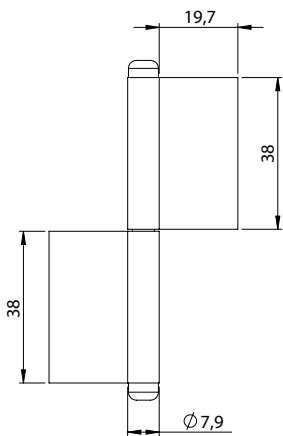
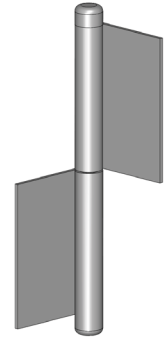

Version 2

Left or right application options.

Material	Version	Code	Code
		Left	Right
Sheet steel, uncoated Pin: Steel	1	390-V1-L	390-V1-R
	2	390-V2-L	390-V2-R
	3	390-V3-L	390-V3-R

\* All dimensions are in mm

## CONTINUOUS HINGE | 391

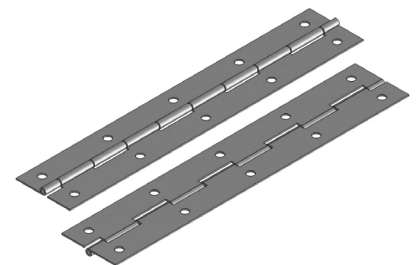
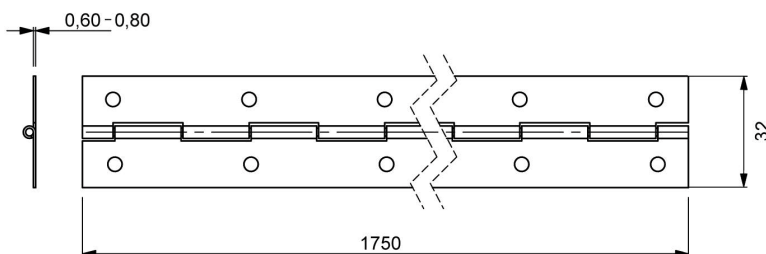

Material	Thickness	Code
Steel sheet, zinc plated Pin: Steel	0,6	391-60
	0,8	391-80

\* All dimensions are in mm